

Welcome at WIMA

**Wilsdruffer
Maschinen- und Anlagenbau GmbH**

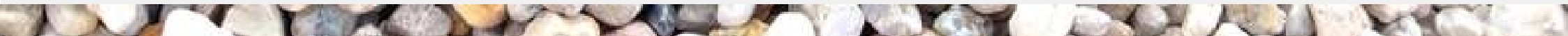

introduction WIMA

wima.
The Complete System

- managing director: Günter Specht & Jörg Thomas
- employees: 85 +
- trainees / students: 3 +
- foundation: 2007
- experience: over 25 years
- locations: Wilsdruff, near Dresden
Hattingen, near Essen
- sales manager for sweden: Stephan Rößler





inquiry



analysis



engineering



design



assembly



adjustments on
changed conditions



inspection at site



check installation situation



creation offers

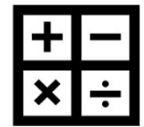

machine adjustment



inspection / service / maintenance



extensive spare parts stock



customers requests



order handling



realisation / production



documentation
of the machine life



satisfied customers

introduction WIMA

wima.
The Complete System



Screening machines



Twin shaft log washers



Sand traps



Bucket wheels



Heavy media separators



Feeders



Steel and sheet metal constructions

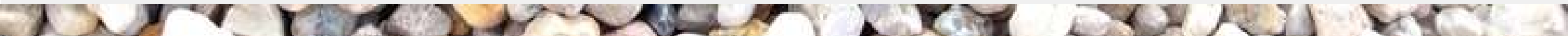

introduction WIMA

wima.
The Complete System

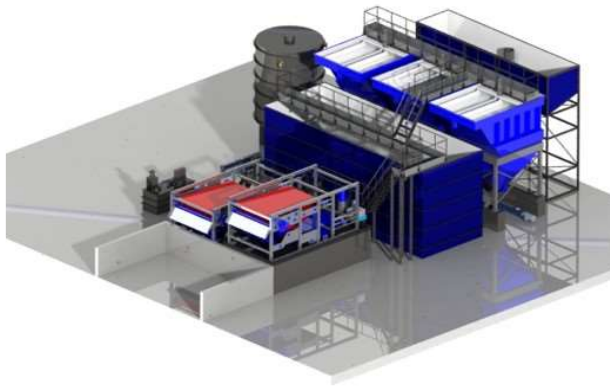

Water treatment
plants



HDS-Series
Recycling Industry



Small Business Projects



What is the target?

wima.
The Complete System

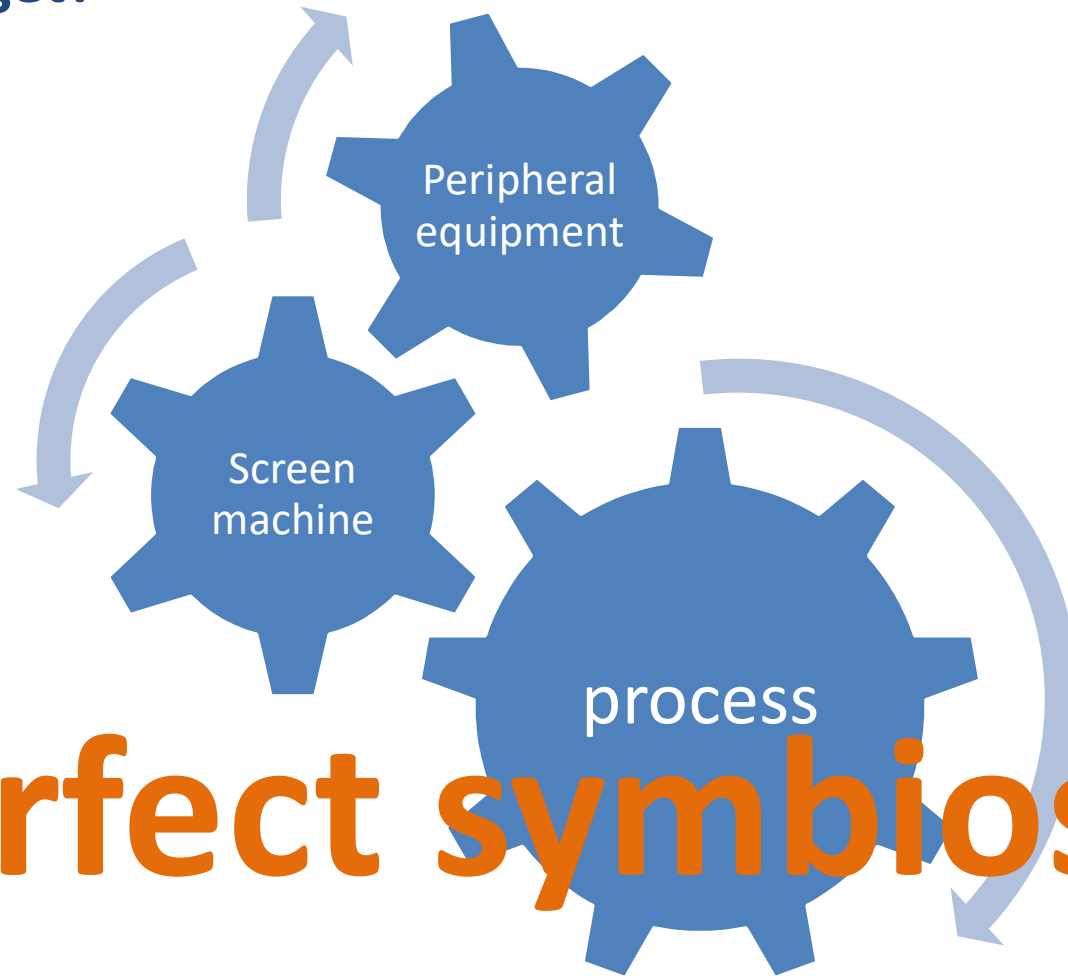

... perfect symbiosis...



What the target?

process

- Grain distribution/ crusher discharge curves
- Grain shape
- Cutting point
- Feed material
- Material moisture
- Layer heights
- Contamination
 - Organic (loam, clay, wood, coal)
 - Chemical (contaminated soil/earth)
- Current screening limits
 - oversize grain, undersize grain
- applicable standards
 - EN 13043 (asphalt)
 - EN 12620 (cement)
 - EN 13450 (track ballast)

Screen machine

- machine
 - manufacturer
 - type, size, inclination
 - number of decks
 - distance of decks
- Machine parameter
 - Stroke, RPM
- Water volume m³/h
- Water pressure
- Nozzle size and number
- Nozzle distance to the screen surface

Peripheral equipment

- feed situation (feeding chute)
- discharge situation
- Continuous wide-area feed
- Type of screening surface currently used
 - Wire, PU
 - supplier
- Mesh size of the screening surface currently in use
- Are there any current problem?
 - Plugging, caking on the screen surface

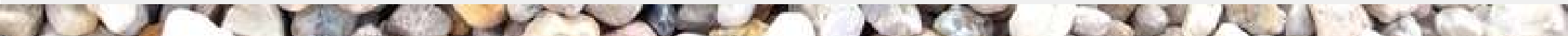

What the target?

process

- Grain distribution/ crusher discharge curves
- Grain shape
- Cutting point
- Feed material
- Material moisture
- Layer heights
- Contamination
 - Organic (loam, clay, wood, coal)
 - Chemical (contaminated soil/earth)
- Current screening limits
 - oversize grain, undersize grain
- applicable standards
 - EN 13043 (asphalt)
 - EN 12620 (cement)
 - EN 13450 (track ballast)

Screen machine

- machine
 - manufacturer
 - type, size, inclination
 - number of decks
 - distance of decks
- Machine parameter
 - Stroke, RPM
- Water volume m³/h
- Water pressure
- Nozzle size and number
- Nozzle distance to the screen surface

Peripheral equipment

- feed situation (feeding chute)
- discharge situation
- Continuous wide-area feed
- Type of screening surface currently used
 - Wire, PU
 - supplier
- Mesh size of the screening surface currently in use
- Are there any current problem?
 - Plugging, caking on the screen surface

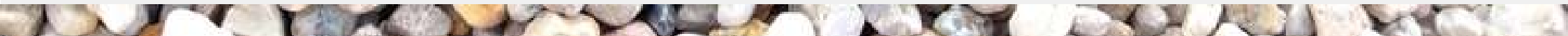

What is the target?

wima.
The Complete System

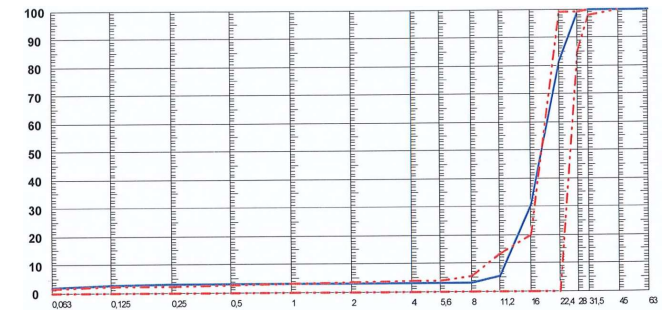

400 t/h

0 - 150 mm

Naturmaterial

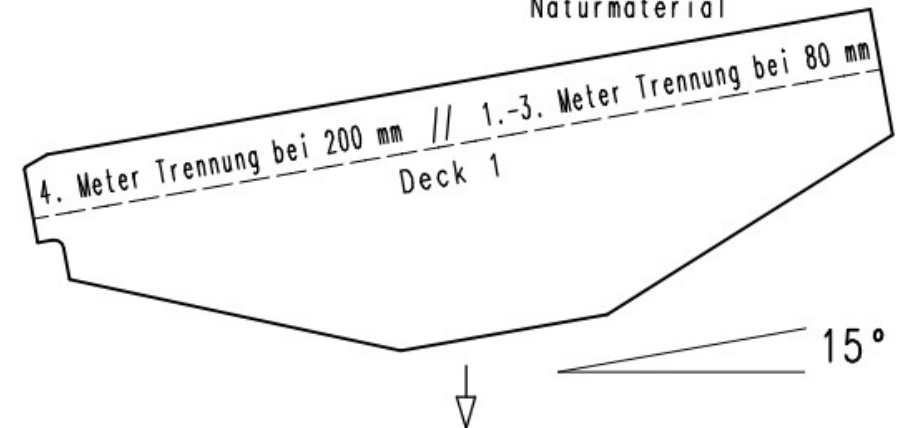

What the target?

process

- Grain distribution/ crusher discharge curves
- Grain shape
- Cutting point
- Feed material
- Material moisture
- Layer heights
- Contamination
 - Organic (loam, clay, wood, coal)
 - Chemical (contaminated soil/earth)
- Current screening limits
 - oversize grain, undersize grain
- applicable standards
 - EN 13043 (asphalt)
 - EN 12620 (cement)
 - EN 13450 (track ballast)

Screen machine

- machine
 - manufacturer
 - type, size, inclination
 - number of decks
 - distance of decks
- Machine parameter
 - Stroke, RPM
- Water volume m³/h
- Water pressure
- Nozzle size and number
- Nozzle distance to the screen surface

Peripheral equipment

- feed situation (feeding chute)
- discharge situation
- Continuous wide-area feed
- Type of screening surface currently used
 - Wire, PU
 - supplier
- Mesh size of the screening surface currently in use
- Are there any current problem?
 - Plugging, caking on the screen surface



A photograph of a large industrial machine, likely a paper mill component, featuring a large metal frame, a yellow safety barrier, and a series of rollers or brushes. The machine is situated in a factory setting with a metal grate floor and a bright light source in the background.

[illegible]

What the target?

process

- Grain distribution/ crusher discharge curves
- Grain shape
- Cutting point
- Feed material
- Material moisture
- Layer heights
- Contamination
 - Organic (loam, clay, wood, coal)
 - Chemical (contaminated soil/earth)
- Current screening limits
 - oversize grain, undersize grain
- applicable standards
 - EN 13043 (asphalt)
 - EN 12620 (cement)
 - EN 13450 (track ballast)

Screen machine

- machine
 - manufacturer
 - type, size, inclination
 - number of decks
 - distance of decks
- Machine parameter
 - Stroke, RPM
- Water volume m³/h
- Water pressure
- Nozzle size and number
- Nozzle distance to the screen surface

Peripheral equipment

- feed situation (feeding chute)
- discharge situation
- Continuous wide-area feed
- Type of screening surface currently used
 - Wire, PU
 - supplier
- Mesh size of the screening surface currently in use
- Are there any current problem?
 - Plugging, caking on the screen surface



What is the target?

wima.
The Complete System

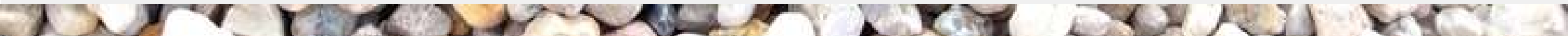
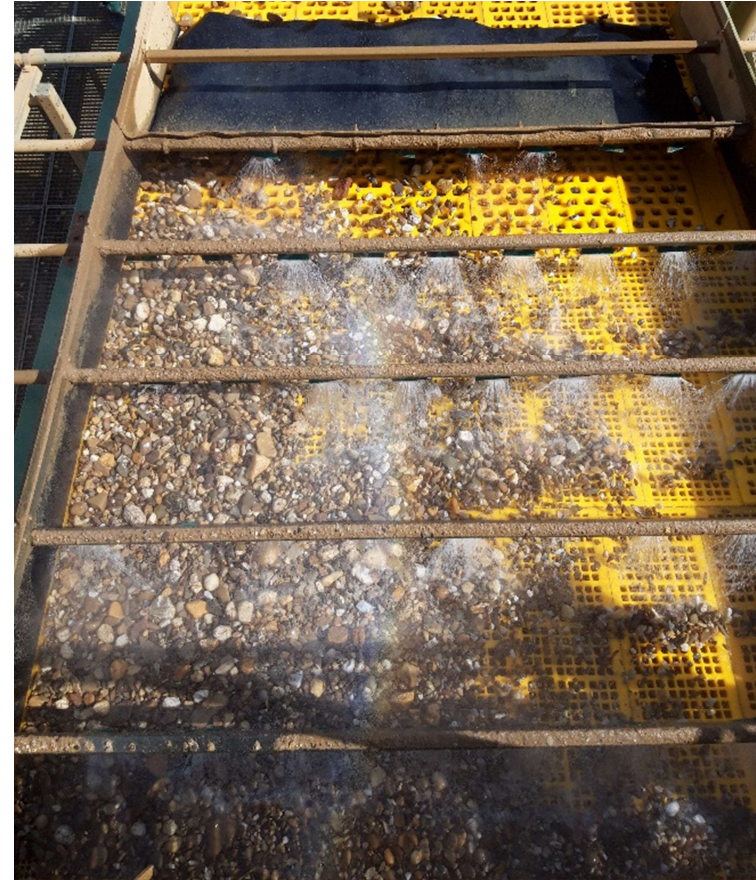

Small Business Projects (screen stations)

wima.
The Complete System



existing screen station



Small Business Projects (screen stations)

wima.
The Complete System

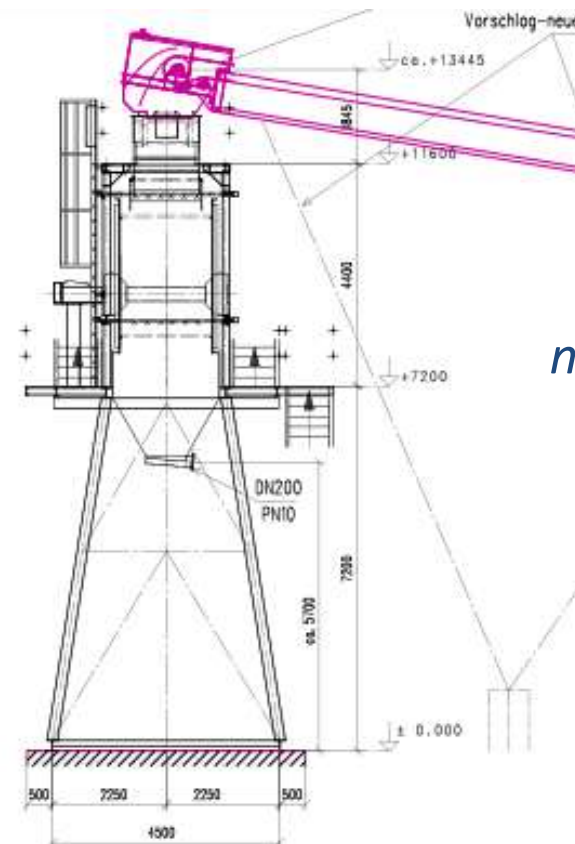
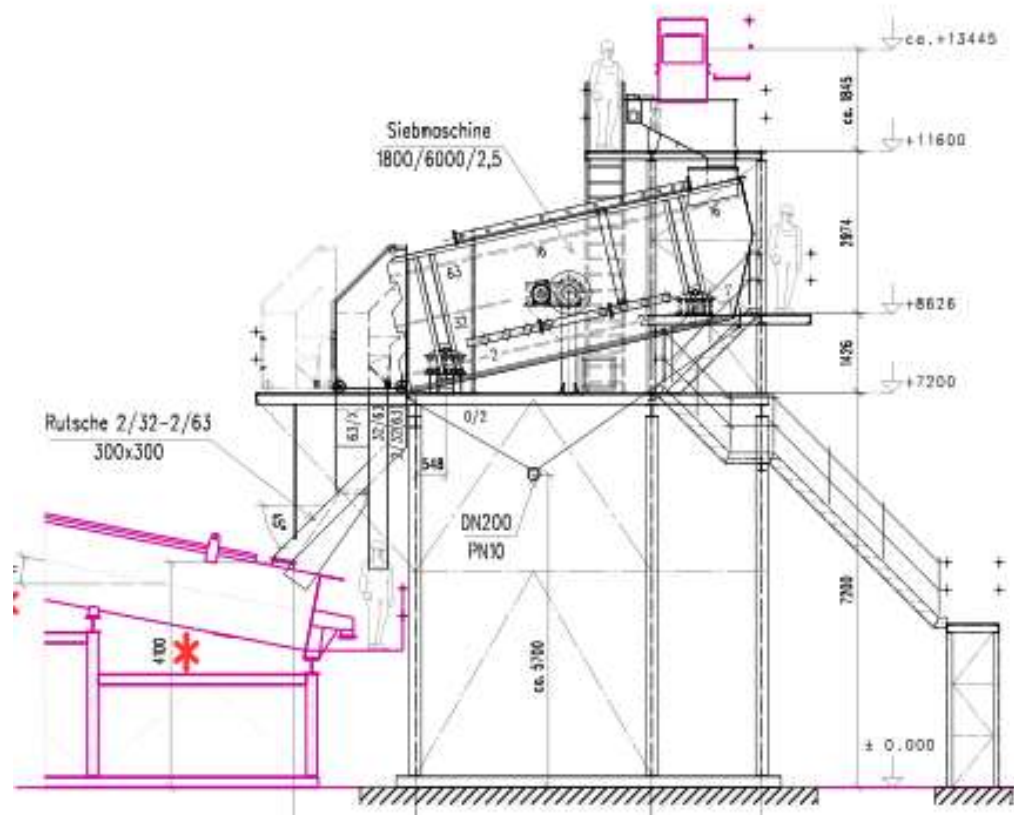

*Layout
new screen station*

Small Business Projects (screen stations)

wima.
The Complete System



New screen station



Small Business Projects (dewatering machine with cyclon)

wima.
The Complete System



Small Business Projects (dewatering machine with cyclon)

wima.
The Complete System

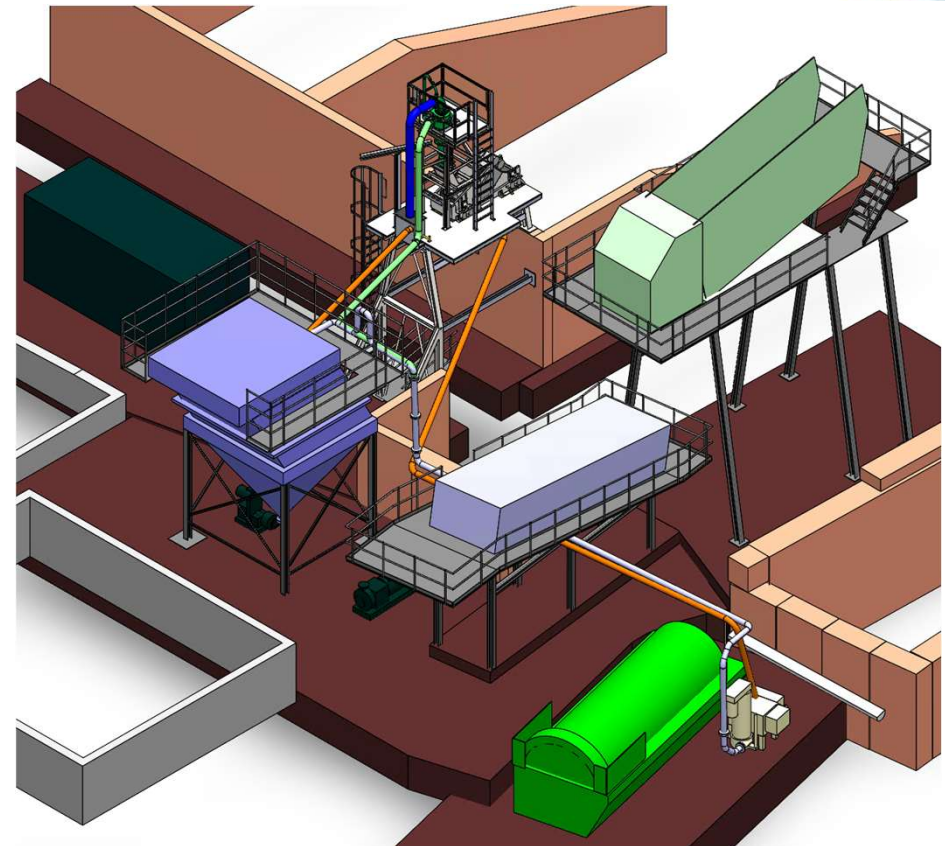
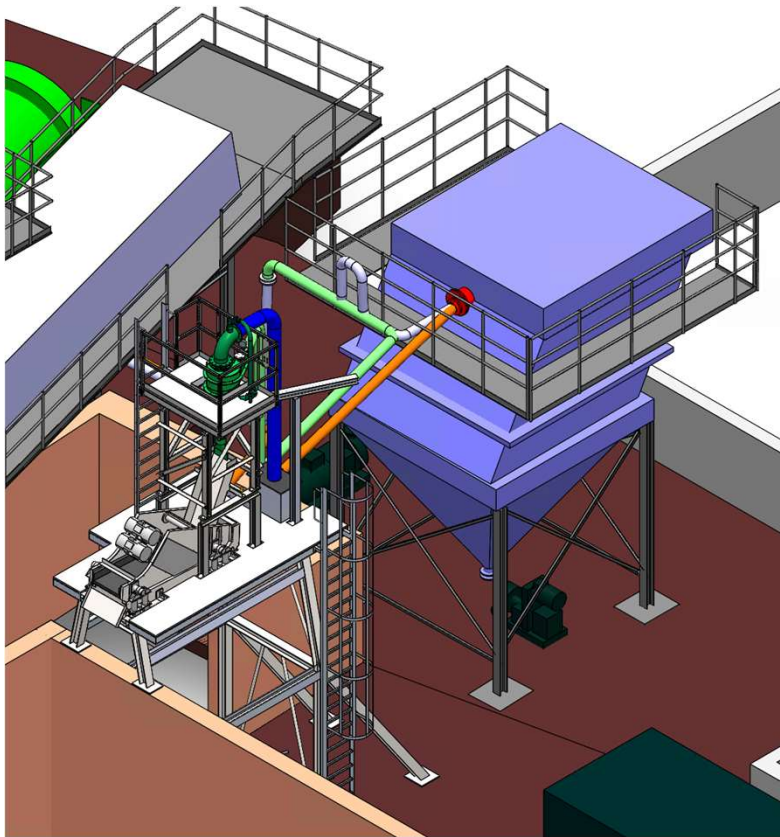

Small Business Projects (Log washer with silo)

wima.
The Complete System

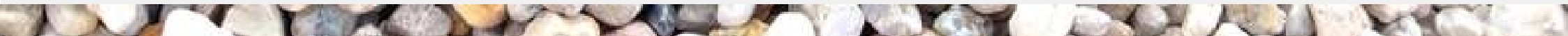

introduction WIMA

Screening machines

wima.
The Complete System

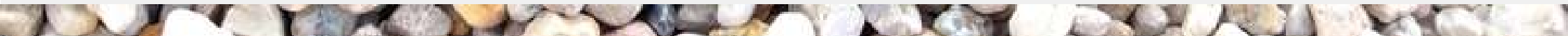
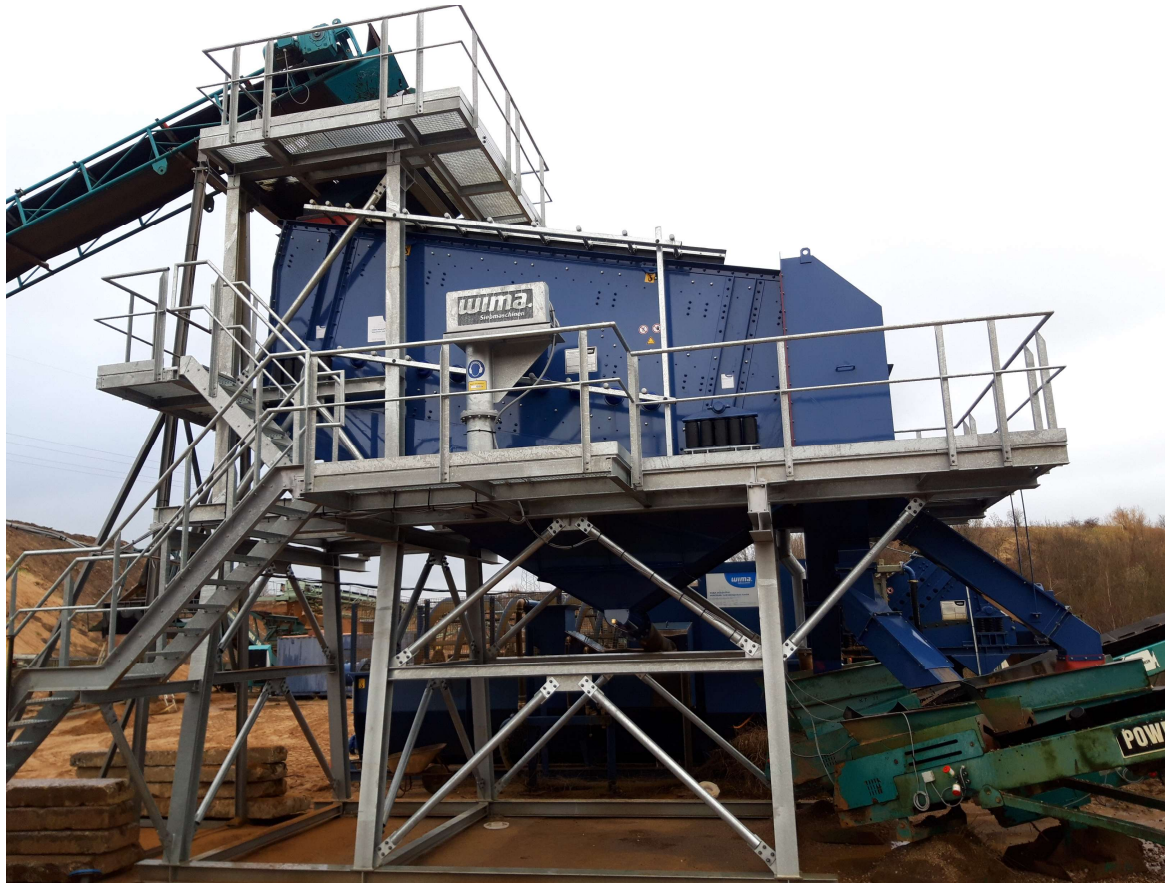

introduction WIMA

Screening machines

wima.
The Complete System

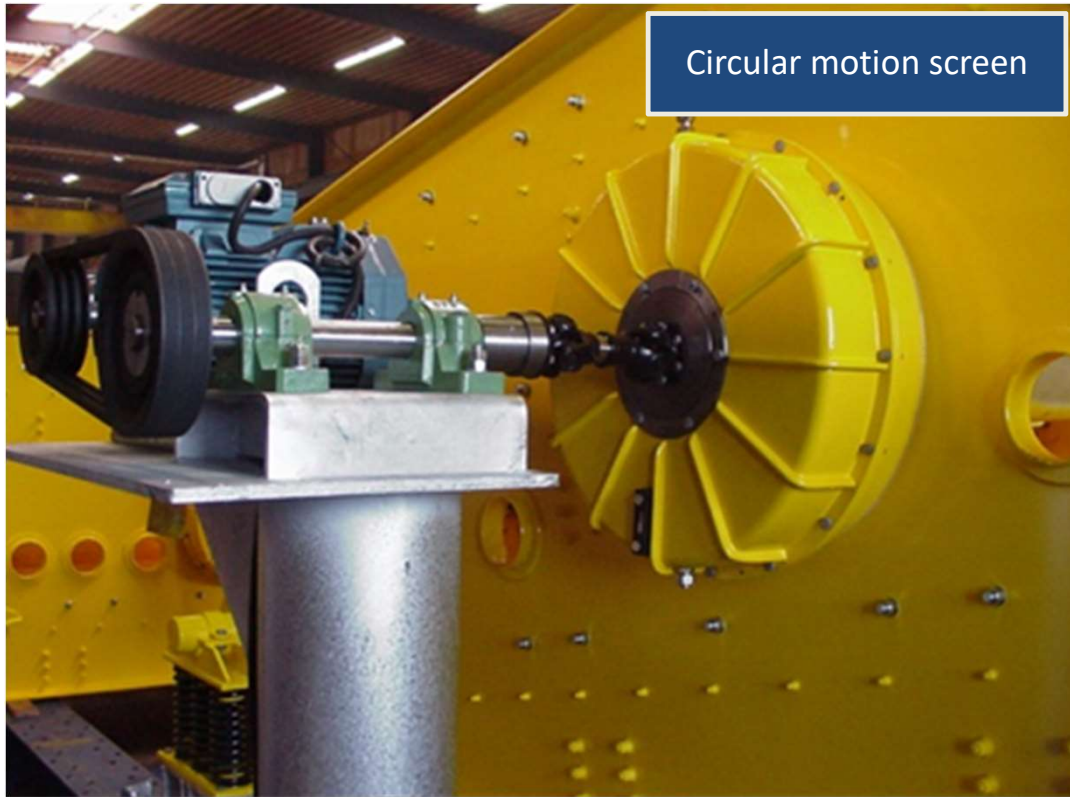

Circular motion screen



elliptical motion screen



introduction WIMA

Screening machines

wima.
The Complete System

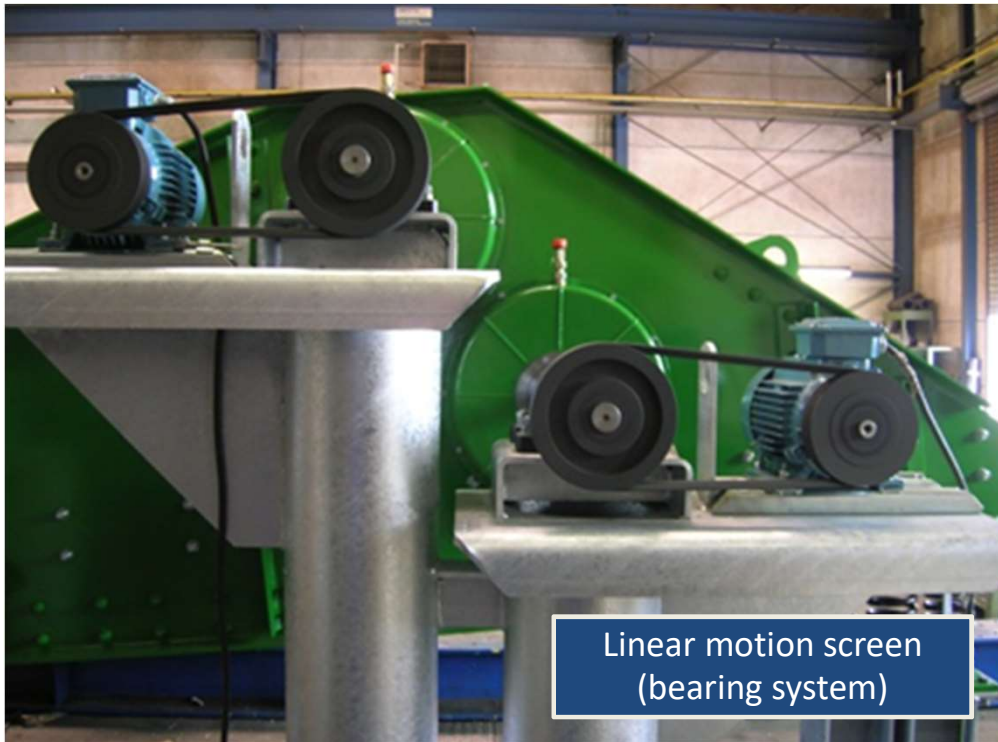

introduction WIMA

Screening machines

wima.
The Complete System



1-Deck



2-Deck



2,5-Deck



3-Deck

WIMA drive systems

Intermediate shaft / single bearing system

wima.
The Complete System



WIMA drive systems *Intermediate shaft / multiple bearing system*



Synchronised double bearing system



WIMA bearing systems

Comparison single and multiple bearing system

Prinzipskizzen zu Lagervarianten

Einfachlagerung

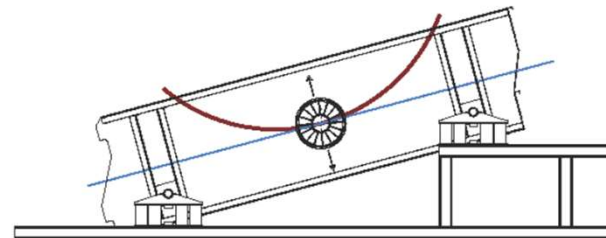
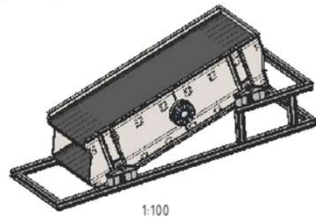

Verlauf ungünstig im Direktvergleich

Doppellagerung

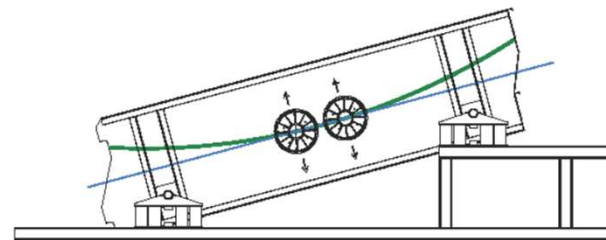
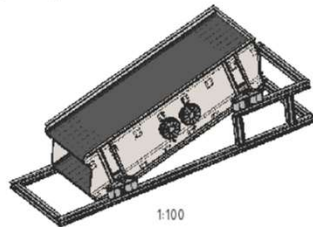

Verlauf günstig im Direktvergleich

(Maschinennummer/Bauwerk)						Maßstab 1:50		Gewicht	
						(Drahtmaß)			

WIMA drive systems

Vibrating motors

wima.
The Complete System



WIMA bearing system

wima.
The Complete System



**Bearing system with oil
splash and mist lubrication**

WIMA bearing system

wima.
The Complete System

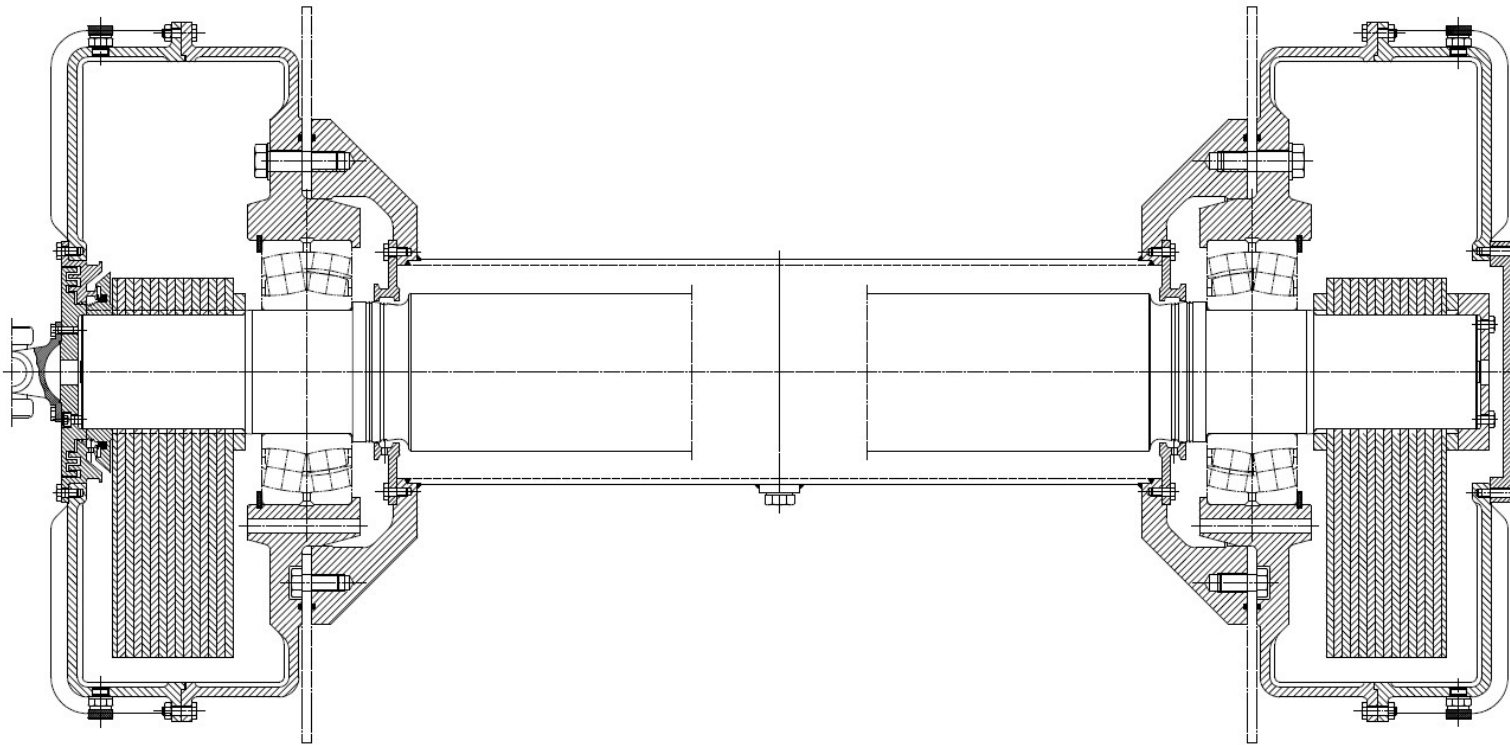

WIMA wear protection

wima.
The Complete System



WIMA wear protection

*Shaft protection tube / flange
combination PU / rubber*

wima.
The Complete System

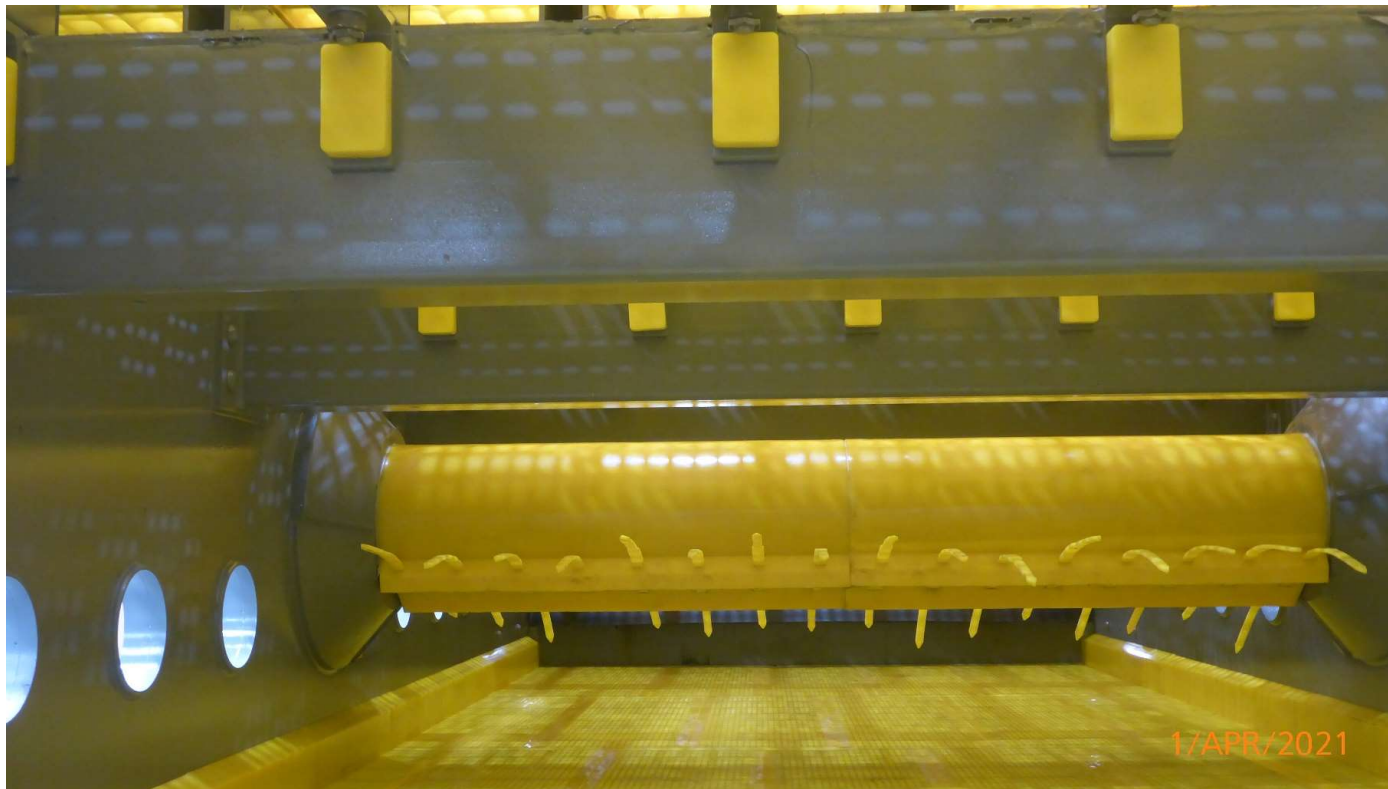

WIMA wear protection

Side walls / cross bearers

wima.
The Complete System



Wear protective rubber
standard: SH 60/6 mm

options for cross bearers / side walls:

SH 60/10 mm

SH 40/6 mm

SH 40/10 mm

PU- magnet system WS 2.10

WIMA wear prodection

Cross beam PU-magnet system

wima.
The Complete System



03.01.2024

33

WIMA wear protection

Longitudinal bearers

wima.
The Complete System



**Longitudinal bearers made of C-Profil
for PU-/rubber modular systems**

- easy exchangeable
- support „Huck- bolted“ on cross bearer
- wear protection for Huck- bolts made of PU

WIMA screen media systems

wima.
The Complete System



*offset after each meter
for an optimal screening
process, no blind zones
along the total length
of the machine*



*sealing side protection bars / screen media
no backtracking of the material, fastening
without wedges*

WIMA screen medias from all well- know manufacturers
according customers request for all applications

wima.
The Complete System



WIMA screen medias from all well- know manufacturers
according customers request for all applications

wima.
The Complete System



WIMA spraying system

wima.
The Complete System

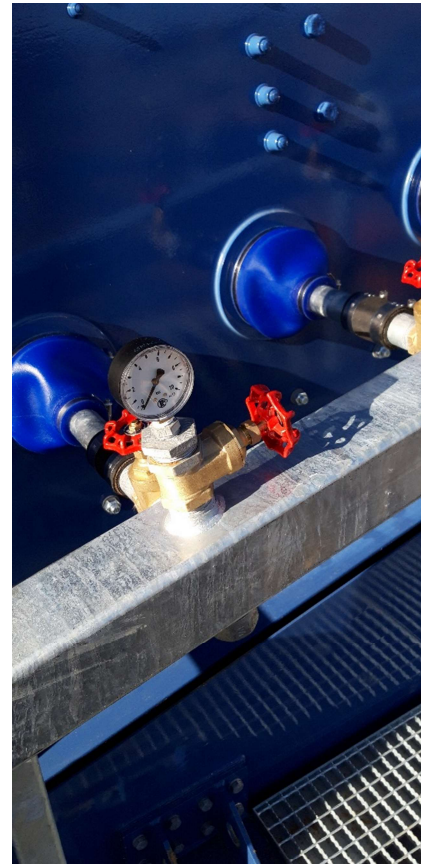

WIMA special features



- tried and tested on the market since 1993
- Longitudinal girder offset for PU modular systems, thus preventing blind running of the screened material
- standard and non-standard screens (screen replacement in the existing steel structure) dimensioning and adaptation of the screening machines to the local conditions
- low oil quantities, no susceptible recirculating oil lubrication
- simple bearing change possible by replacing the bearing unit
- constant availability of spare parts due to standardization of components
- strong service team / availability from 6.00 a.m. to 3.00 p.m.

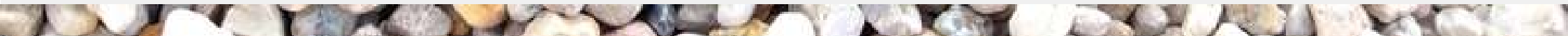

WIMA Twin shaft log washers

wima.
The Complete System



WIMA Twin shaft log washers

wima.
The Complete System



WIMA sand traps

wima.
The Complete System



WIMA heavy media separators

wima.
The Complete System

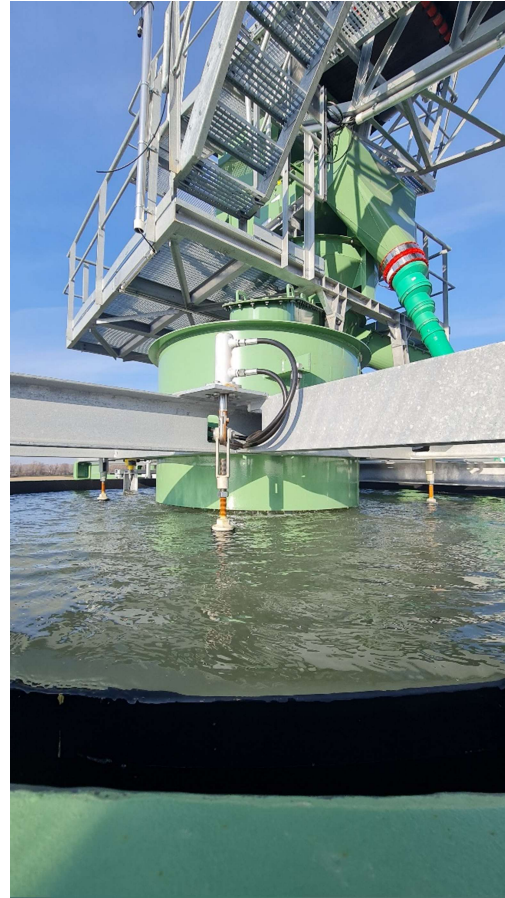

Our WIMA Team ...

wima.
The Complete System

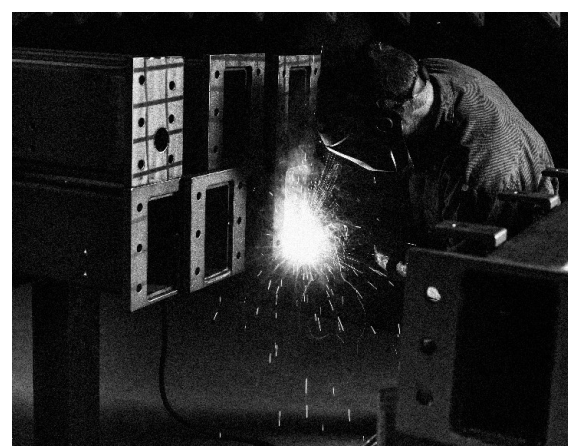
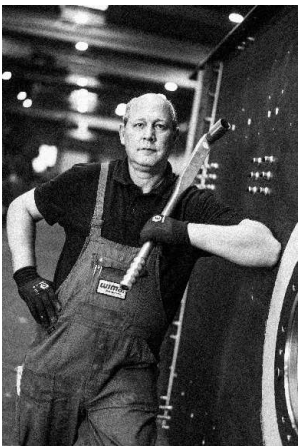
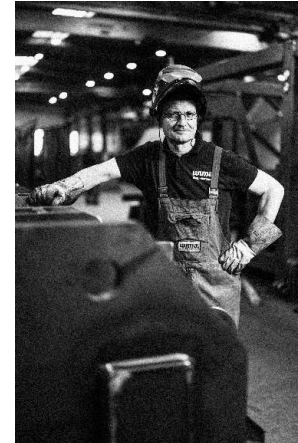
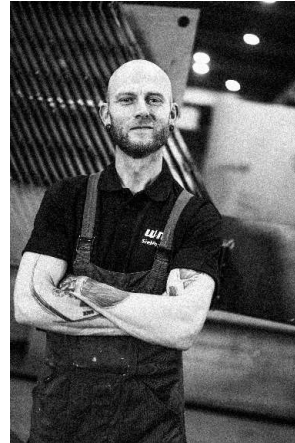
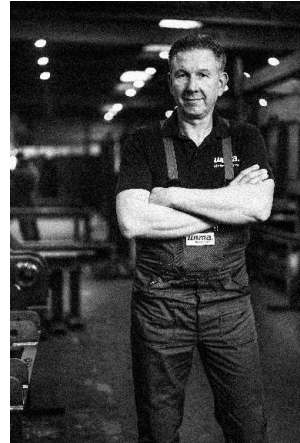
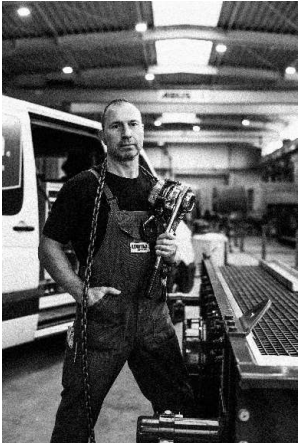

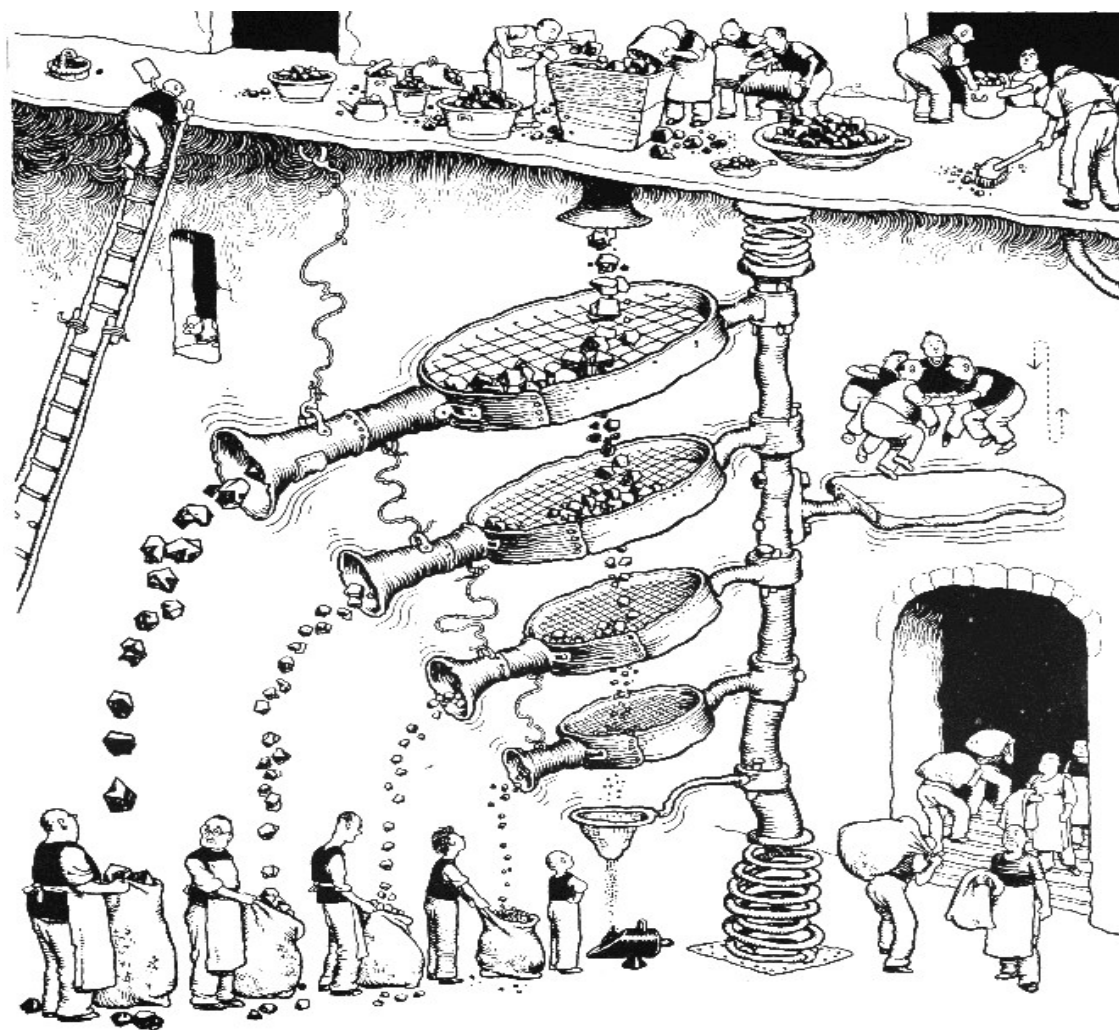

Coke Grading